

Self-administering the test (1 of 2)

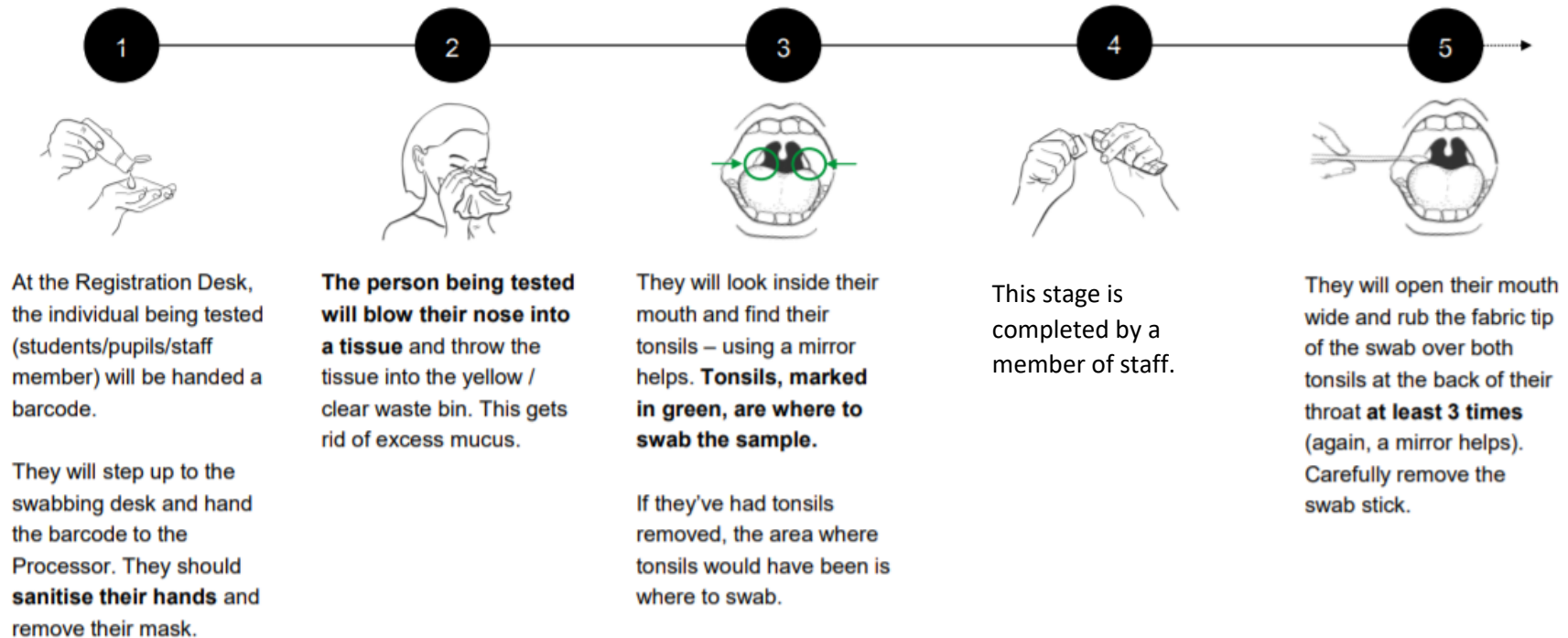

! *If the student/pupil is unable to self administer the test, administered swabbing should be completed by a trained member of staff.

Self-administering the test (2 of 2)

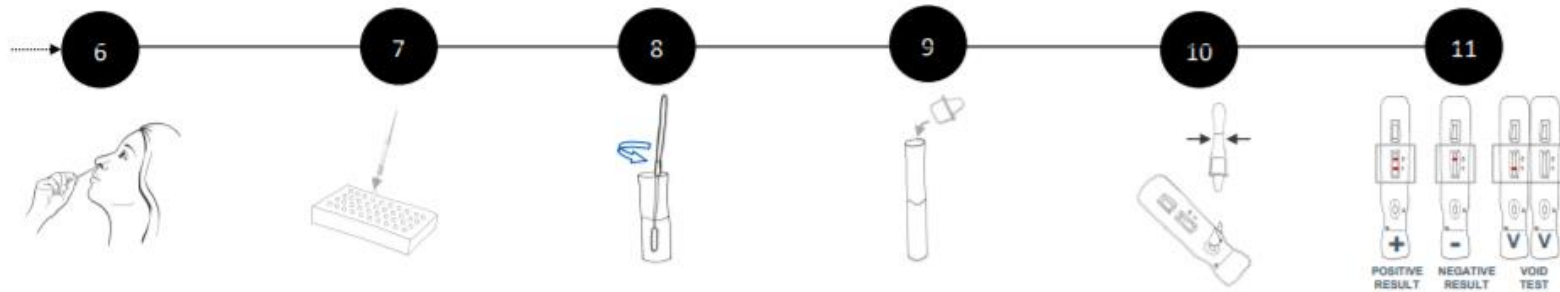

Time to swab the nose. They should **put the same end of the same swab gently into one nostril until they feel a slight resistance (about 2.5cm up the nose)**. Rotate the swab 5 times and slowly remove it. They only need to sample one nostril

This stage is completed by a member of staff.

This stage is completed by a member of staff.

This stage is completed by a member of staff.

This stage is completed by a member of staff.

This stage is completed by a member of staff.